

Supporting Individuals Living With HIV Following Incarceration

Lara Strick, MD, MSc

Infectious Disease Physician, WA DOC
Clinical Associate Professor, UW
Corrections Program Director, MWAETC



Disclosures

No conflicts of interest or relationships to disclose

Corrections 101:

JAILS

- County or town
- Operated by Sheriff's department or Tribal
- Pre- & Post-sentencing
- Term of incarceration generally < 1 year
- House innocent, those with misdemeanors & felonies



PRISONS

- State or federal
- Operated by State Dept of Corrections or BOP
- Post-sentencing
- Term of incarceration generally > 1 year
- House those w/felonies only



Jails vs. Prison Population Single Point in Time

Prison

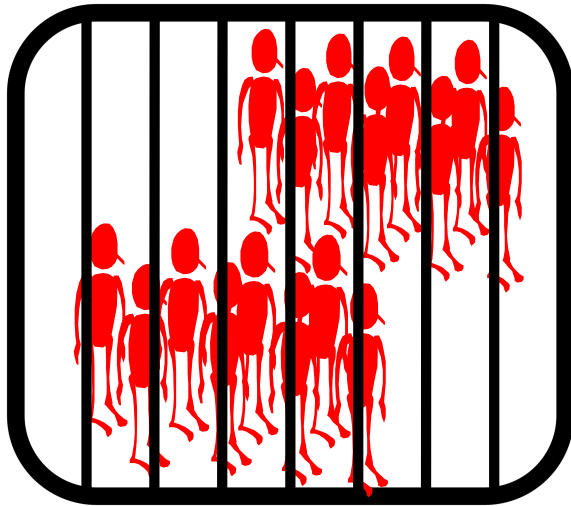

1.6 Million

Jail

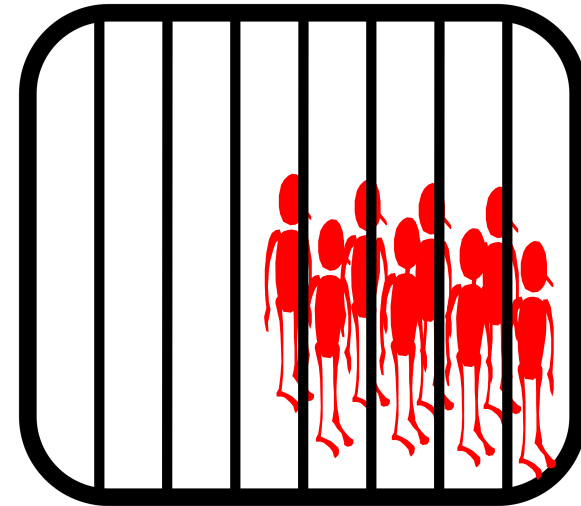

0.8 Million

On any given day, approximately twice as many individuals are in prison than jail.

Jails vs. Prison Population Across Time

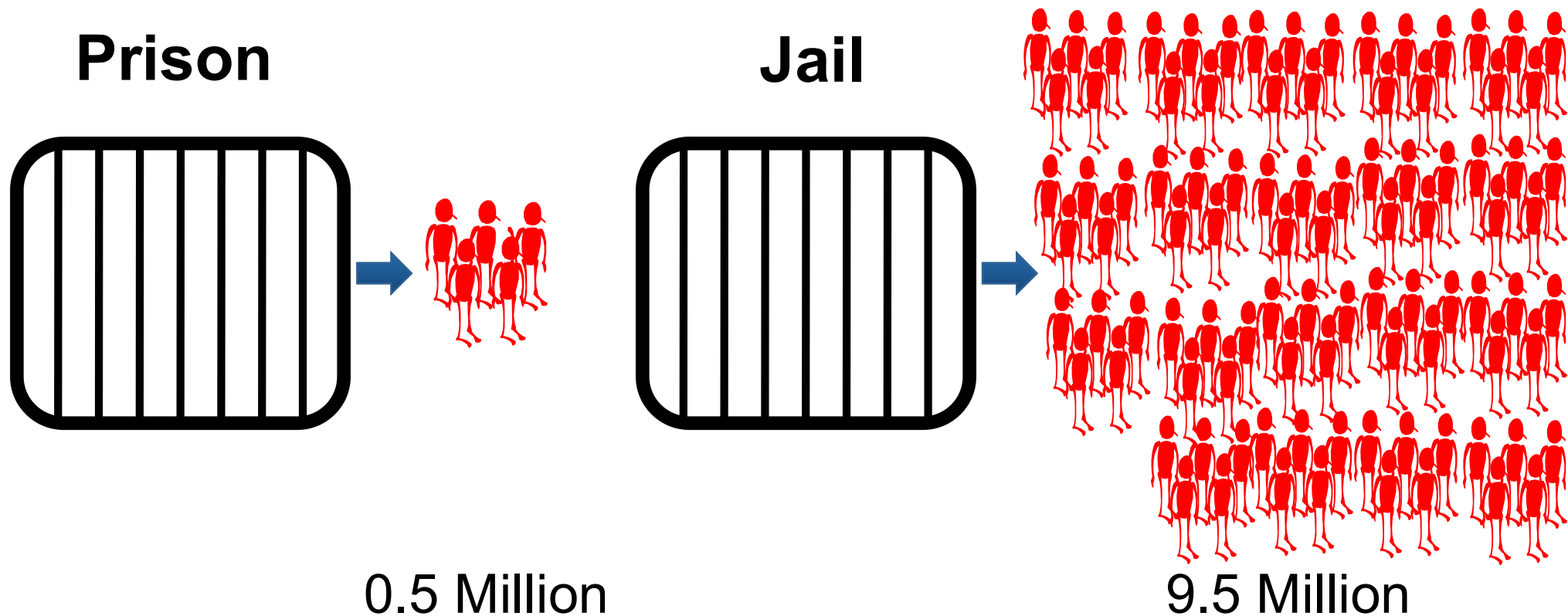

Each year, approximately 95% of the 10 million individuals released from the criminal justice system are from jails

More Definitions

- Probation: conditional release instead of incarceration
- Parole (Community Supervision): conditional release after completing at least part of term of incarceration
- Work release: mandatory work in the setting of partial incarceration



Corrections 101: WA State

- 37 County Jails
 - King County Jail
 - King County Correctional Facility – Downtown
 - Maleng Regional Justice Center – Kent, WA

- 19 City Jails
 - Issaquah City Jail
 - Kent City Jail
 - Kirkland City Jail
 - Lynnwood City Jail
 - SCORE (Des Moines)

- 7 Tribal Jails

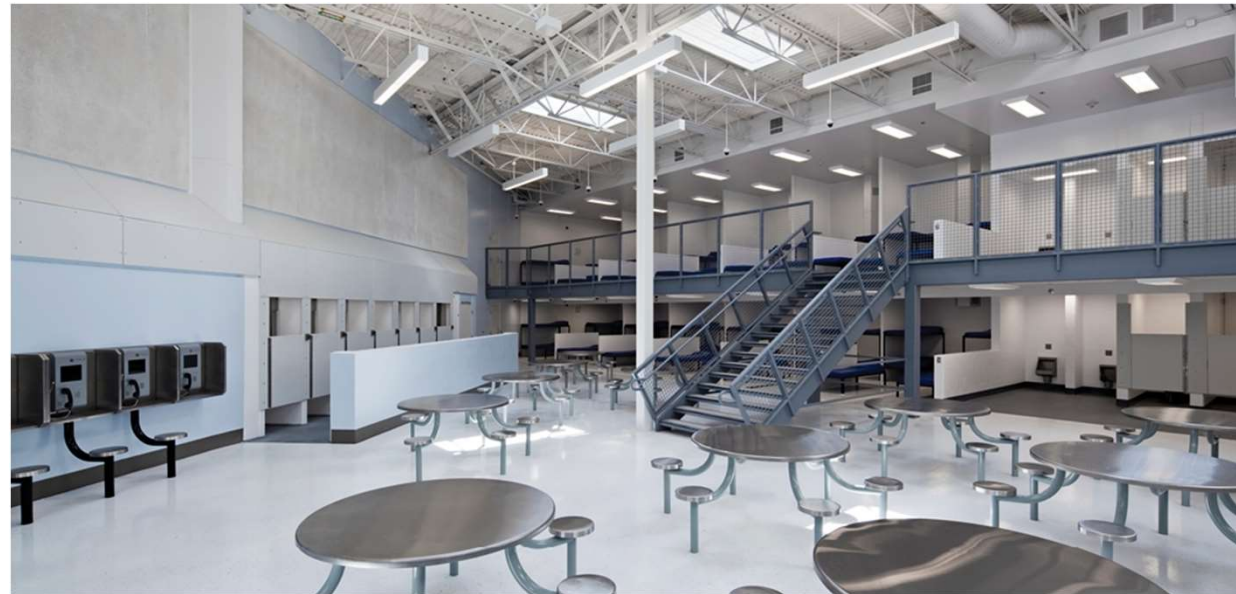

- 26 Juvenile Detention Centers & JRA Facilities
 - King County Juvenile Detention Center (Seattle)
 - Echo Glen Children's Center (Snoqualmie)

Corrections 101: WA State

- 12 State Prisons
 - None in King County
- 12 DOC Work Release Facilities
 - Bishop Lewis Work Release
 - Reynolds Work Release
 - Helen B. Ratcliff Work Release
- 1 Federal Detention Center (BOP)
 - Sea-Tac Federal Detention Center
- 1 Immigration & Customs Enforcement (ICE) Facility
 - Northwest Detention Center (Tacoma)



Benefits of Transitional Care

- Continuity of care
- Education regarding medical & social services available post-release
- Decrease costs associated with preventative medical events & duplication of services pre- & post-release
- Provides support around re-integration into the community

Mortality Rates among Formerly Incarcerated of the WA State DOC

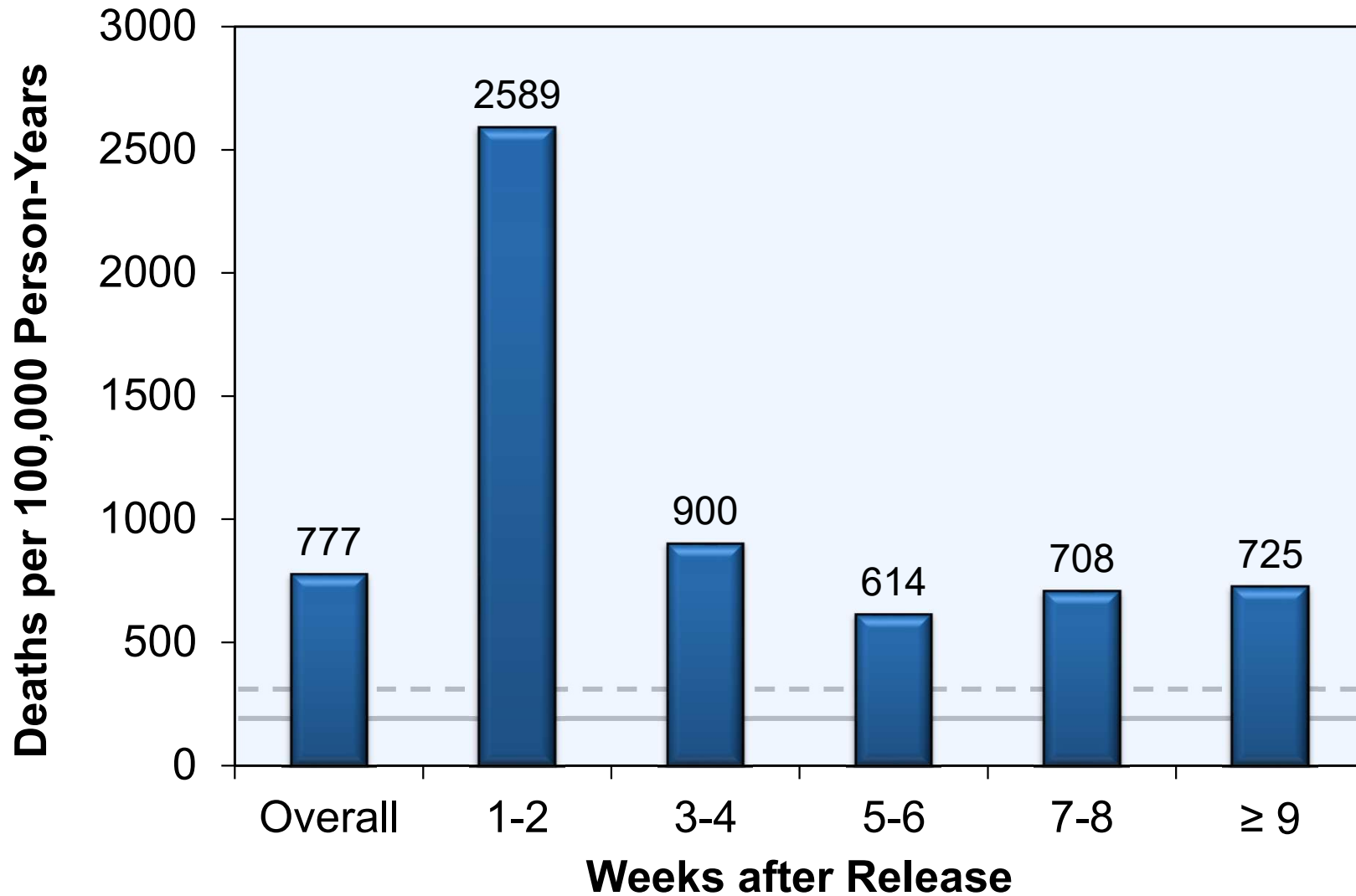

Prison Release & Antiretroviral Prescriptions

% of Inmates that filled their antiretroviral prescriptions after release

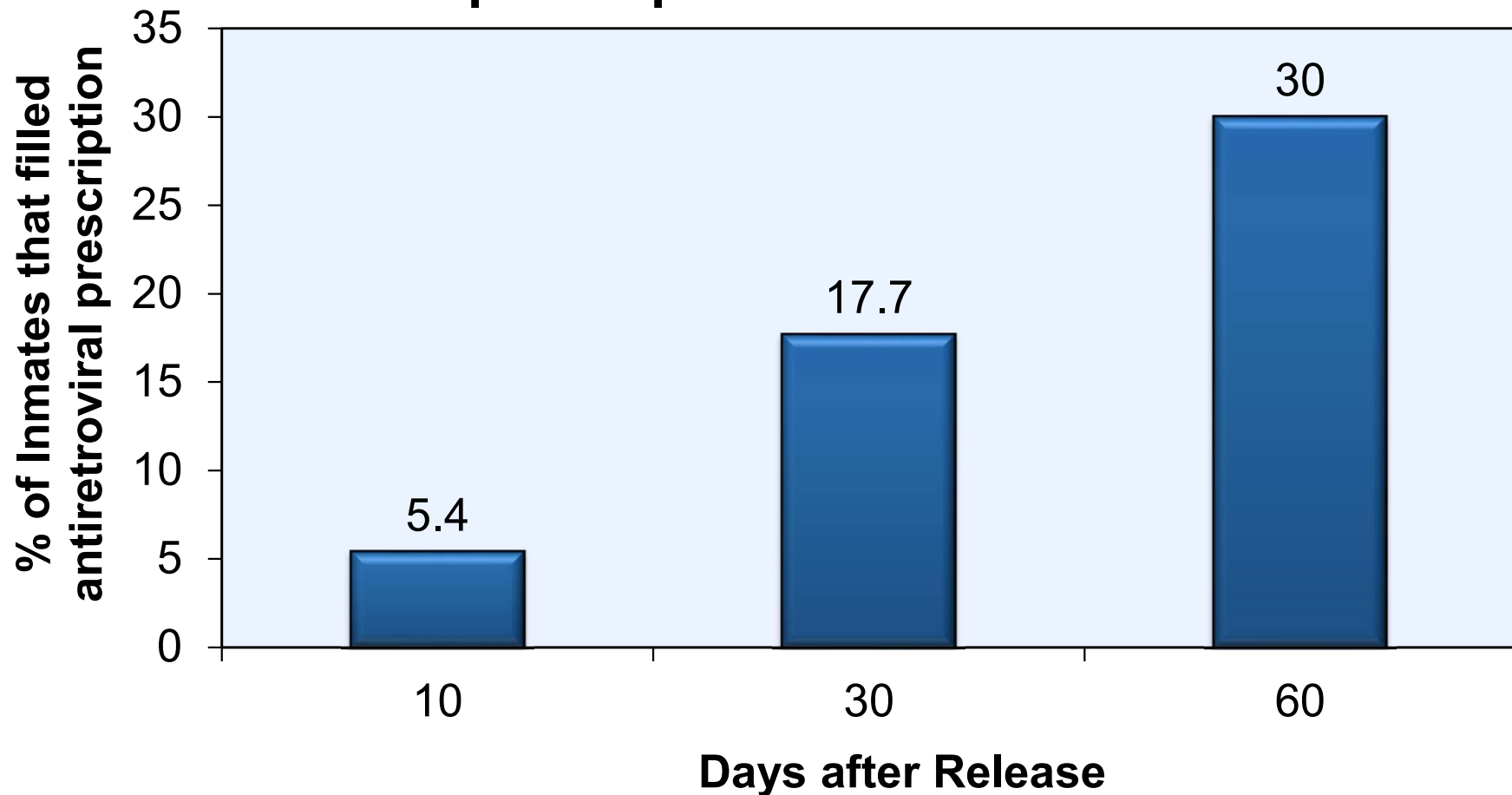

Effect of Prison Release on HIV Control

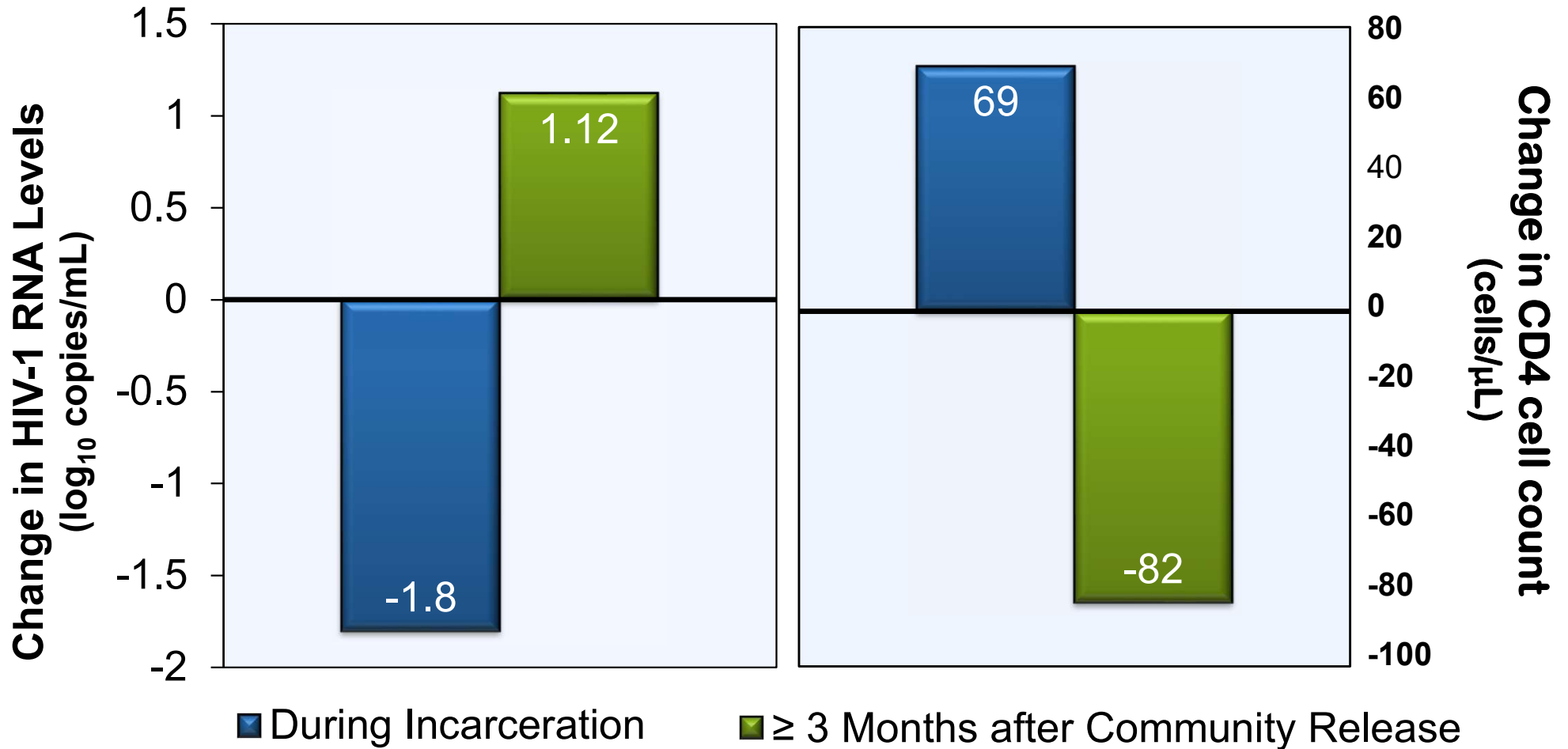

Post-Release Needs

Housing, employment or disability,
social support & re-integration with
family, re-gaining parental rights

Addiction & MH services,
transportation, legal ID,
community custody
expectations

Health insurance,
healthcare
& Rx

Components of Release Plan

- Adequate discharge medications
 - 30 day supply
- Adequate insurance coverage in the community
- Linkage to community providers:
 - Medical practitioner
 - Case manager
 - Meet & establish relationship prior to release
 - Support post-release
 - Need date and time of appointments in hand at time of release
 - Fax records
- Special services based on need
 - Mental health follow-up
 - Substance use treatment

Components of Release Plan

- Transportation
- Food
- Clothing
- Valid identification
- Disability
- Peer support
 - Stigma
 - Marginalization & Isolation
 - Adherence
- Legal issues
 - Community custody expectations
 - GPS
 - Parental rights
 - Fines

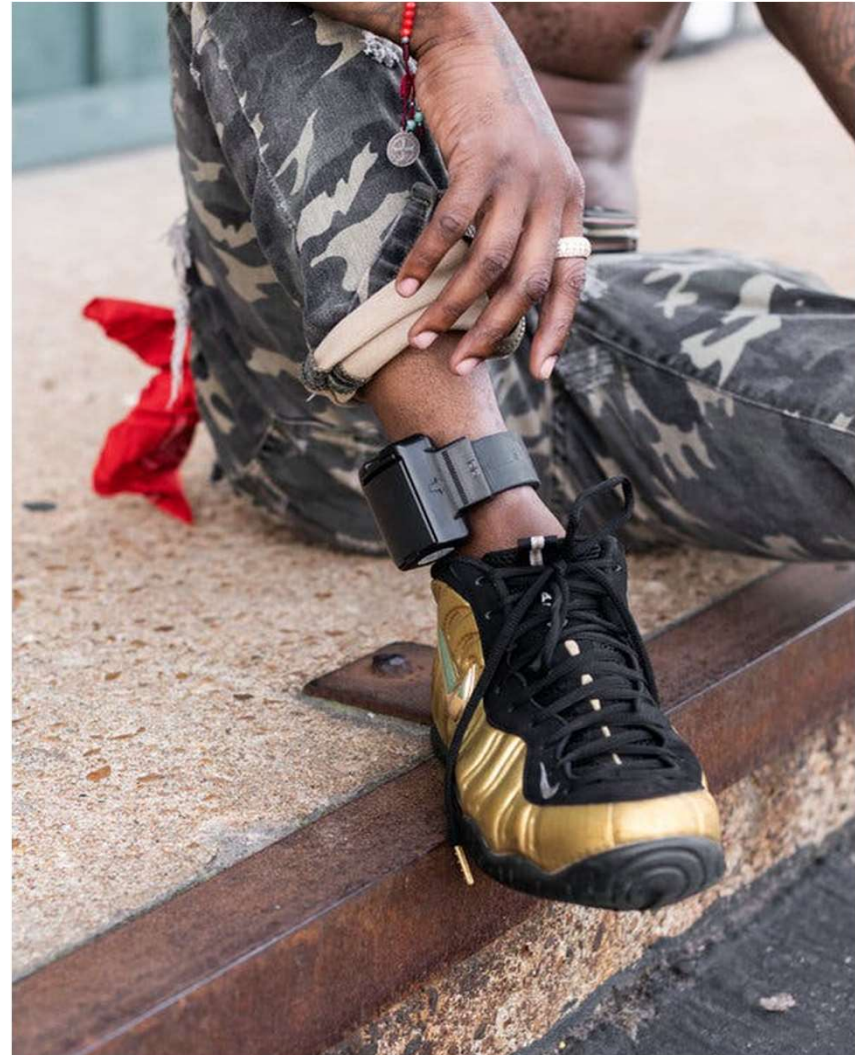

Components of Release Plan

Housing!!

- Types of Housing
 - Emergency housing – hotel/motel
 - Shared/Group living
 - Independent apartment
- Funding
 - DOC ERD voucher
 - DOH
 - Ryan White
- DOC Housing Case Management



Weld Seattle, Project 1426

Medications for Opiate Use Disorder (MOUD)

- Relapse is one of primary reasons for lack of adherence to ART post-release
- Providing MOUD improves HIV clinical endpoints & reduces recidivism
- Pre-release MOUD for people living with HIV is effective way to improve ART adherence & linkage to care in community
- Co-located services in the community improves engagement in ongoing HIV care

Barriers

- Date & time of release often unknown
 - Prison vs. Jail
 - 35 day victim notification
 - Notification for sexual offenses
 - Need for approved address for some violent offenses
- Anxiety about re-entering ‘old stomping ground’ vs. starting over
- Desire to celebrate (risk for over-dose & re-arrest)
- Distrust
 - Duty to report
 - Frequency of visits



KCJ Care Coordination Calls

- King County Jail
- King County Public Health
- MAX Clinic
- Madison Clinic
- Department of Corrections
- Bailey Boushay
 - Day Health
 - Shelter
 - Housing
 - HEET

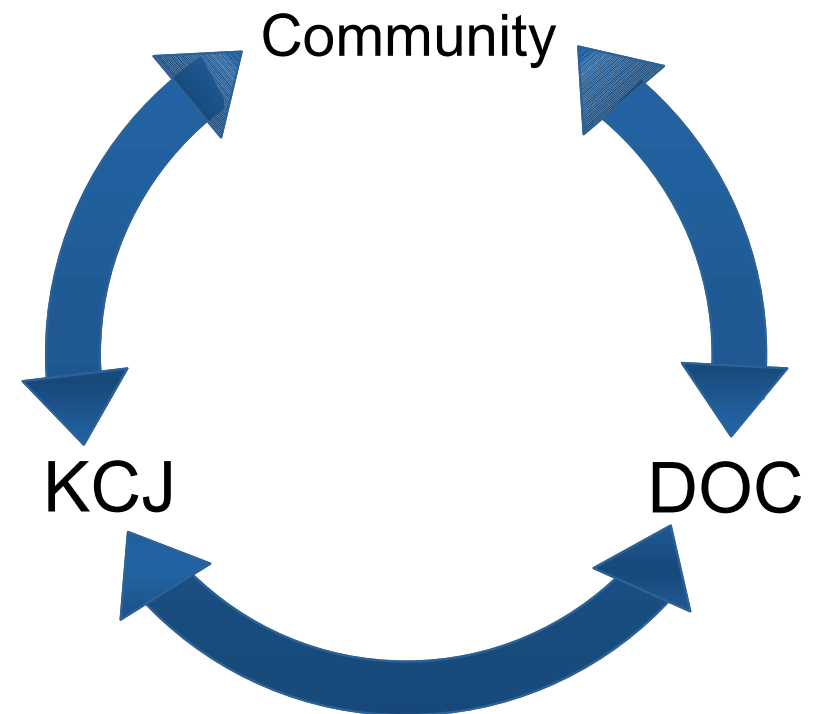



Questions